

Trough Conveyor Roller Dimensions

Belt Width	102mm L1	102mm A	102mm L2	114mm L1	114mm A	114mm L2	127mm L1	127mm A	127mm L2	133mm L1	133mm A	133mm L2
450	172	192	222	172	192	222	172	192	222	172	192	222
500	187	207	237	187	207	237	187	207	237	187	207	237
600	222	242	272	222	242	272	222	242	272	222	242	272
650	242	262	292	242	262	292	242	262	292	242	262	292
750	276	292	326	276	296	326	276	296	326	276	296	326
800	293	313	343	293	313	343	293	313	343	293	313	343
900	329	349	379	329	349	379	329	349	379	329	349	379
1000	358	378	408	358	378	408	358	378	408	358	378	408
1050	381	401	431	381	401	431	381	401	431	381	401	431
1200	434	454	484	434	454	484	434	454	484	434	454	484
1350							488	508	538	488	508	538
1400							494	514	544	494	514	544
1500							541	561	591	541	561	591
1600							561	581	611	561	581	611
1800							626	646	676	626	646	672



Notes:

- 102mm with 20mm shaft & 114mm with 20mm shaft - Steel trough rollers supplied with 6204 bearings
- 127mm with 25mm shaft - steel trough rollers & 133mm with 25mm shaft - steel/impact rollers supplied with 6205 bearings

Manufacturing Tolerances:

- Roller face dimensions L1 +/- 1.5mm
- Normal O.D of roller shell +/- .3mm

Special Feature Notes:

- Slots are all 14 x 10mm
- Shafts have square cut ends & square cut slots
- Ends are to LECS/MINSPEC design
- Rollers have polished edges and are painted in RAL 7004 colour with RAL3028 colour end caps

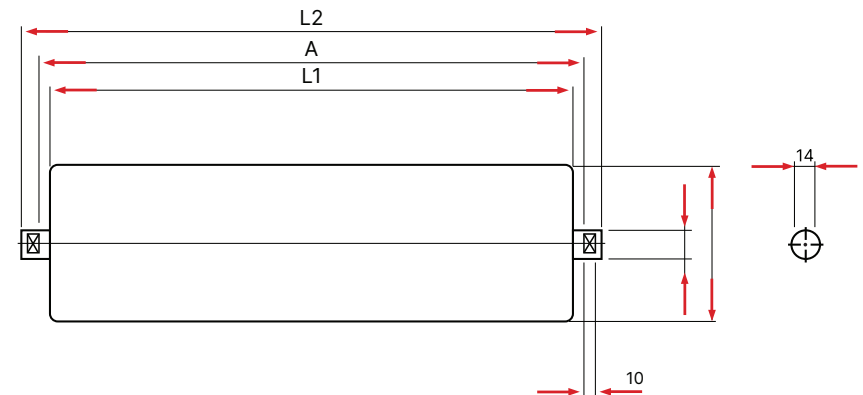

Return Conveyor Roller Dimensions

Belt Width	102mm L1	102mm A	102mm L2	114mm L1	114mm A	114mm L2	127mm L1	127mm A	127mm L2	133mm L1	133mm A	133mm L2
450	542	562	592	542	562	592	542	562	592	542	562	592
500	592	612	642	592	612	642	592	612	642	592	612	642
600	692	712	742	692	712	742	692	712	742	692	712	742
650	743	763	793	743	763	793	743	763	793	743	763	793
750	843	863	893	843	863	893	843	863	893	843	863	893
800	893	913	943	893	913	943	893	913	943	893	913	943
900	993	1013	1043	993	1013	1043	993	1013	1043	993	1013	1043
1000	1093	1113	1143	1093	1113	1143	1093	1113	1143	1093	1113	1143
1050	1143	1163	1193	1143	1163	1193	1143	1163	1193	1143	1163	1193
1200	1293	1313	1343	1293	1313	1343	1293	1313	1343	1293	1313	1343
1350							1495	1515	1545	1495	1515	1545
1400							1545	1565	1595	1545	1565	1595
1500							1644	1664	1694	1644	1664	1694
1600							1845	1865	1895	1845	1865	1895
1800							2046	2066	2096	2046	2066	2096



Notes:

- 102mm with 20mm shaft & 114mm with 20mm shaft - Steel trough rollers supplied with 6204 bearings
- 127mm with 25mm shaft - steel trough rollers & 133mm with 25mm shaft - steel/impact rollers supplied with 6205 bearings

Manufacturing Tolerances:

- Roller face dimensions L1 +/- 1.5mm
- Normal O.D of roller shell +/- .3mm

Special Feature Notes:

- Slots are all 14 x 10mm
- Shafts have square cut ends & square cut slots
- Ends are to LECS/MINSPEC design
- Rollers have polished edges and are painted in RAL 7004 colour with RAL3028 colour end caps

