

INSTALLATION, OPERATING & MAINTENANCE MANUAL

KEYSKIRT® SIZE 1 CHUTE SEALING SYSTEM

PATENTED

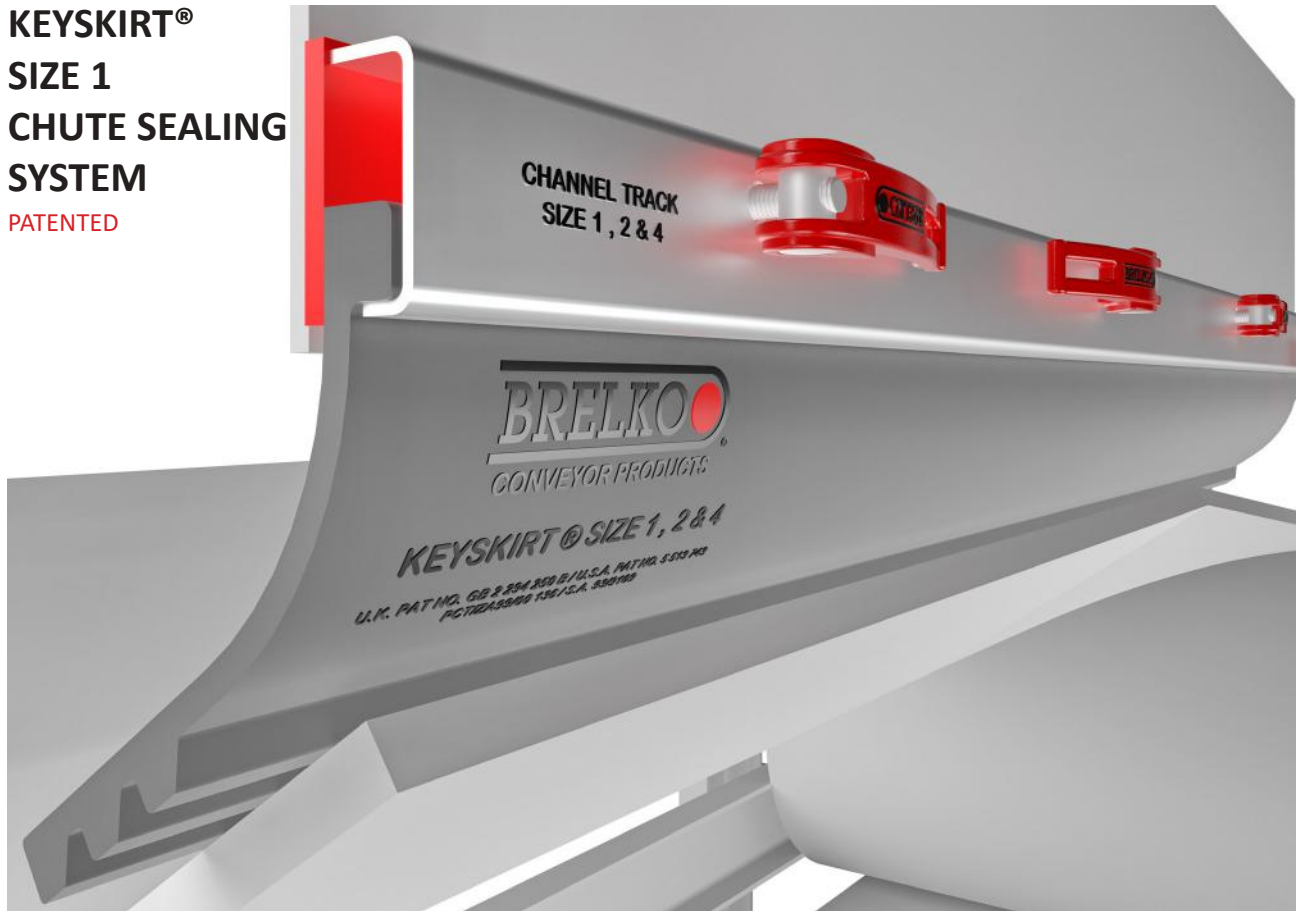

| | | |
|-------------------|---|---|
| Project Name | : | . |
| Project Number | : | . |
| Order Number | : | . |
| | : | . |
| Model Number | : | . |
| Purchase Date | : | . |
| Purchased From | : | . |
| Installation Date | : | . |
| | : | . |

Model number information can be found on the Label found on the scraper carton.

This information will be helpful for any future inquiries or questions about belt scraper replacement parts, specifications or troubleshooting.

Table of Contents

| | | |
|-------|---|-----|
| 1. | Disclaimer _____ | 367 |
| 2. | Safety Note _____ | 367 |
| 3. | The following symbols may be used in this manual: _____ | 367 |
| 4. | General Information _____ | 367 |
| 4.1. | Application and Features (Standard System). _____ | 368 |
| 4.2. | Reference Drawing - KS1-007 _____ | 369 |
| 5. | Handling _____ | 370 |
| 5.1. | Receiving the goods _____ | 370 |
| 5.2. | Work Safety _____ | 370 |
| 5.3. | Handling _____ | 371 |
| 5.4. | Storage _____ | 371 |
| 5.5. | Preparations for installing Belt Scrapers _____ | 371 |
| 5.6. | Recommended Tools List _____ | 371 |
| 6. | Maintenance _____ | 372 |
| 6.1. | New Installation _____ | 372 |
| 6.2. | Routine Visual Inspection (every 2~4 weeks) _____ | 372 |
| 6.3. | Parts List and Assembly Instructions. _____ | 373 |
| 6.4. | Reference Drawing - KS1-008 _____ | 374 |
| 6.5. | Reference Drawing - KS1-021 _____ | 375 |
| 6.6. | Reference Drawing - KS1-022 _____ | 376 |
| 6.7. | Installation Guide _____ | 377 |
| 6.8. | Reference Drawing - KS1-009 _____ | 378 |
| 6.9. | Reference Drawing - KS1-023 _____ | 379 |
| 6.10. | Reference Drawing - KS1-024 _____ | 380 |
| 7. | Procedure for Replacing Keyskirt® _____ | 381 |
| 8. | Maintenance Log _____ | 382 |
| 9. | Conveyor Belt & Equipment Check List _____ | 383 |
| 10. | Trouble Shooting _____ | 386 |

1. Disclaimer

Brelko conveyor products (Pty) Ltd hereby disclaims any liability for: damage due to contamination of the material; user's failure to inspect, maintain and take reasonable care of the equipment; injuries or damage resulting from use or application of this product contrary to instructions and specifications contained herein. Brelko's liability shall be limited to repair or replacement of equipment shown to be defective.

2. Safety Note

Observe all safety rules given herein along with owner and Government standards and regulations. Know and understand lockout/tag-out procedures as defined by National Standards Institutes, National Standard for Personnel Protection - Lockout/Tag-out of Energy Sources - Minimum Safety Requirements and Occupational Health and Safety.

3. The following symbols may be used in this manual:



Danger: Immediate hazards that will result in severe personal injury or death.



Warning: Hazards or unsafe practices that could result in personal injury.



Caution: Hazards or unsafe practices that could result in product or property damages.

Important:

Important: Instructions that must be followed to ensure proper installation/operation of equipment.

Note:

Note: General statements to assist the reader.

4. General Information

Brelko Keyskirt® is designed to operate with minimum maintenance. However, to maintain superior performance some service is required. When the Keyskirt® is installed a regular maintenance program should be set up. This program will ensure that the Keyskirt® operates at optimal efficiency and problems can be identified and fixed before the Keyskirt® stops working. All safety procedures for inspection of equipment (stationary or operating) must be observed. Only visual observations can be made while the belt is running. Service tasks can be done only with the conveyor stopped and by observing the correct lockout/Tag-out procedures.

KEYSKIRT® SIZE 1 CHUTE SEALING SYSTEM PATENTED

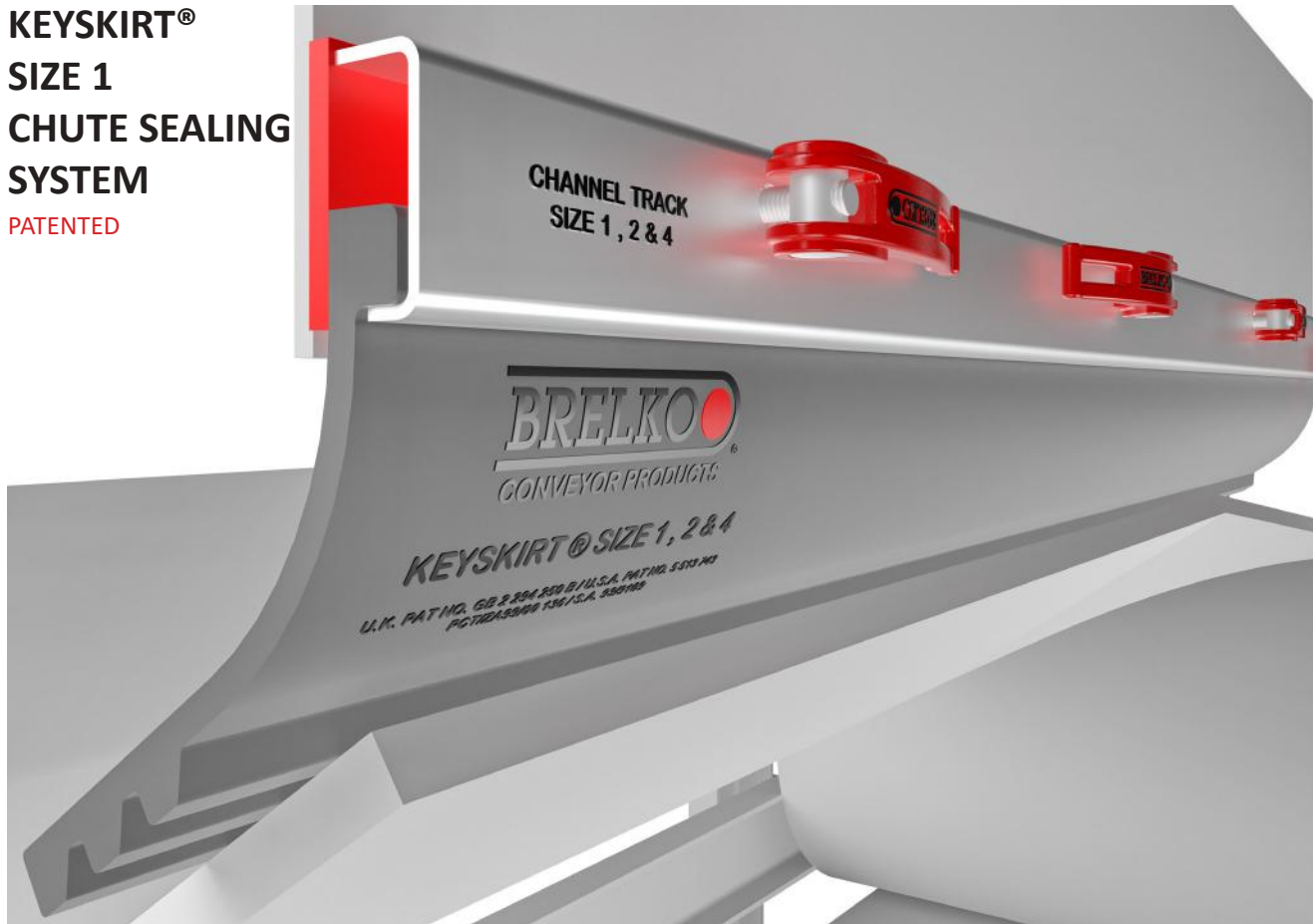

APPLICATIONS

- An effective chute sealing system designed to control spillage at conveyor load areas.
- Suitable for all relatively light belt conveyors carrying material less than 75mm particle size.

FEATURES

- Patented mounting track system results in simple installation and subsequent skirt rubber replacement.
- Self-cleaning grooves trap spillage allowing it to be carried away by the belt.
- Low contact area reduces wear and friction.
- No adjustment required.
- Continuous flexible seal accommodates belt movement.
- Colour coding for easy skirt grade identification.
- Boltless option available for corrosive applications.
- Quick release handles allow quick removal of damaged or worn skirting without the use of hand tools.

GRADES

- | | | |
|--------------------|-----------|---|
| ▪ Standard | - 55SH(A) | |
| ▪ LHB (Soft) | - 40SH(A) | |
| ▪ Heat Resistant | - 55SH(A) | - Fine Material 180°C (356°F) Max |
| | - 55SH(A) | - Coarse Material 220°C (428°F) Max |
| ▪ F.R.A.S.O.R | - 55SH(A) | - Fire Retardant, Anti Static & Oil Resistant |
| ▪ Waste Works | - 60SH(A) | |
| ▪ White Food Grade | - 60SH(A) | - Silicone Rubber (FDA Approved) |
| ▪ Clear Chemical | - 60SH(A) | - Polyurethane |

All technical and dimensional information subject to change. All general Terms and Conditions of sale, including limitations of our liability, apply to all products and services sold.

KEYSKIRT SIZE 1 - CHUTE SEALING SYSTEMS WITH FLEXIBLE RUBBER SKIRTING

© 08-2016

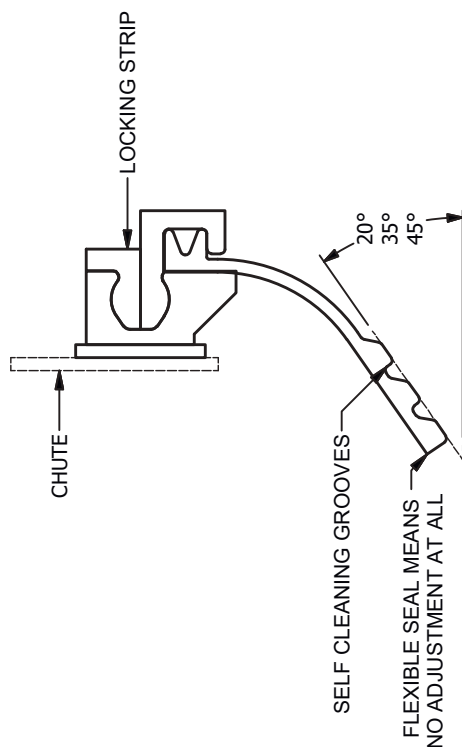

BOLTLESS OPTION

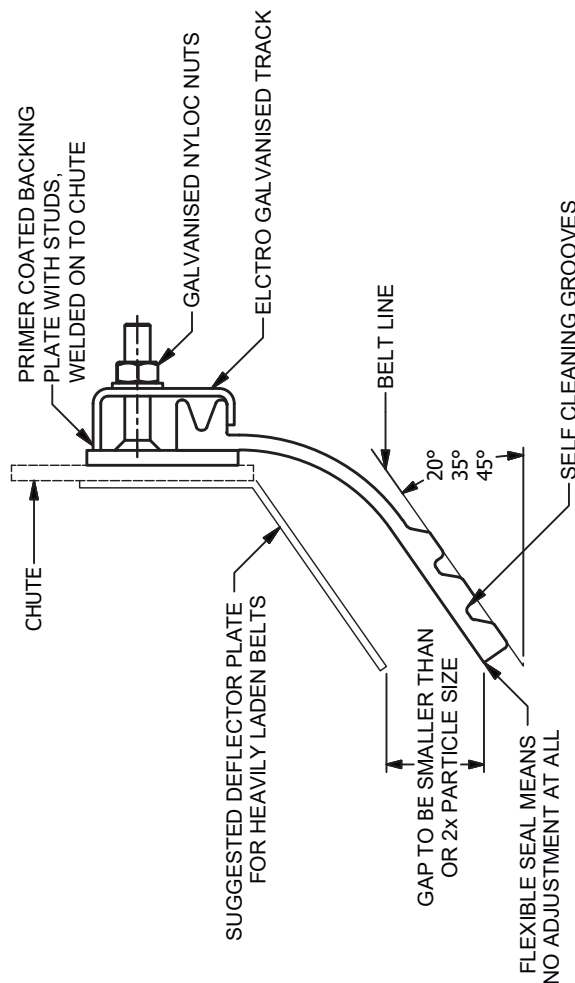

OPTIONAL DEFLECTOR PLATE DETAILS

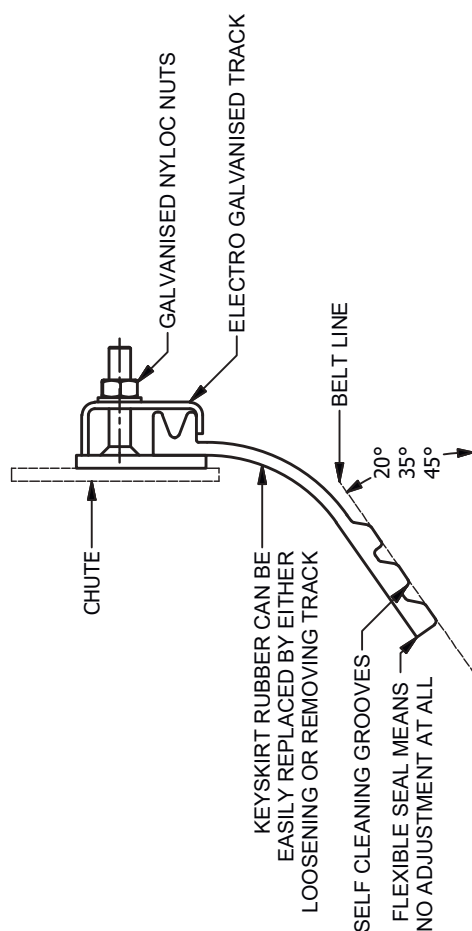

STANDARD CONSTRUCTION & FINISHES

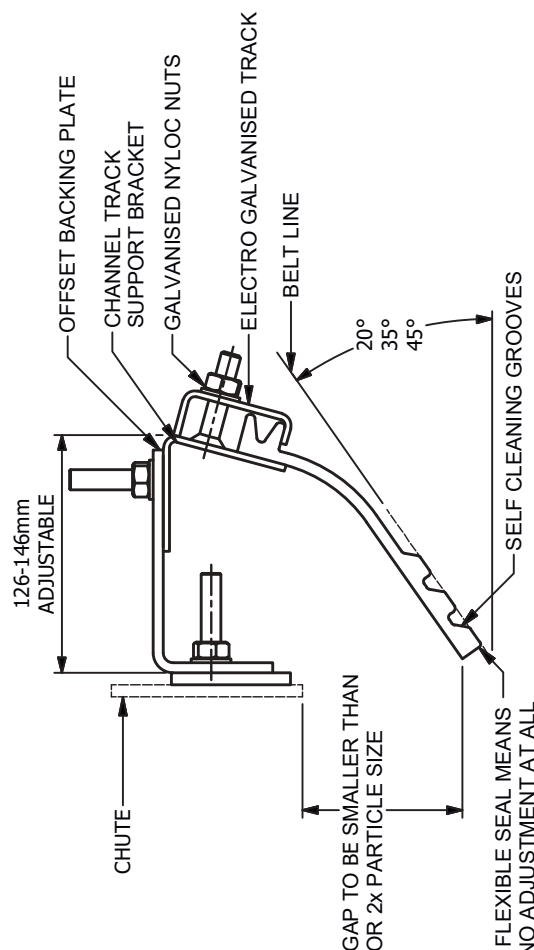

OPTIONAL MOUNTING FOR NARROW CHUTES AND LOWER BELT ANGLES

NOTE: FEATURES & OPTIONS SHOWN:
PLEASE REFER TO DETAILED MANUAL FOR INSTALLATION INSTRUCTIONS, MAINTENANCE & SPARE PARTS

DRW. KS1 - 007
No.

REV. D

5. Handling

5.1. Receiving the goods

Check that the shipment contains all the items specified on the delivery note. If this does not match the delivery note or if the items show any transportation damage, **list it on the freight bill**. Describe the damage and the number of incorrect or faulty items and **contact your supplier immediately**.

Defective parts should not be used under any circumstances. Claims must be made within 8 days from the arrival of goods. Brelko do not cover claims or exchange of product if installation was not carried out according to installation instructions.

5.2. Work Safety

Always use protective gloves and clothing. Always use a lifeline and soft-sole footwear when work will be carried out on raised platforms. Before you move a scraper or plough, check that it is securely attached to the lifting equipment. Always observe local safety regulations.



Before removing/installing equipment, lock out/tag out energy source to conveyor, and/or conveyor accessories.

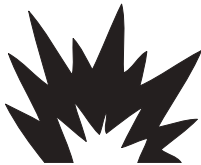

Turn off and lock out/tag out energy source according to local standards.

If equipment will be installed in an enclosed area, test gas level or duct content before using a cutting torch or welding. Using a cutting torch or welding in an area with gas or dust may cause an explosion.

If using a cutting torch or welding machine, test atmosphere for gas level or dust content.

5.3. Handling

When scrapers are unloaded from the transportation vehicle onto customer's platform, place them on boards spaced max 1m apart at a minimum of 5cm from the ground.

5.4. Storage

Scrapers can be stored unpacked or in transportation package. Scrapers must not be stored on top of one another, protect the scrapers by storing them in a cool dry area on a flat surface.

5.5. Preparations for installing Belt Scrapers

Before installation, check all measurements and any of the other geometric design

5.6. Recommended Tools List

| BRELKO KEYSKIRT® | |
|------------------|--|
| QTY | DESCRIPTION |
| 2 | EXTENSION CORD (30m MINIMUM) |
| 1 | PORT-A-PACK (OXY-ACETYLENE) |
| 1 | PRICKER |
| 1 | COMBINATION GAUGE (WITH SPIRIT LEVEL) |
| 1 | STRAIGHT EDGE (1M MINIMUM) |
| 1 | 90° SET SQUARE |
| 1 | 5M TAPE MEASURE |
| 1 | ADJUSTABLE SPANNERS |
| 2 | RINGSET SPANNERS - M13, 15, 16, 17, 18, 19, 24 |
| 1 | STANLEY KNIFE |
| 1 | HARD FACE HAMMER - 4 PD |
| 1 | SOFT FACE HAMMER - 1 KG |
| 1 | NYLON ROPE (3 M) |
| 2 | G-CLAMPS - 6" - 8" |
| 1 | JIMMY LEVER |
| 1 | INVERTER (200 AMP) |
| 1 | WELDING HELMET |
| 1 PAIR | WELDING SPATS |
| 1 | WELDING APRON |
| 1 | FIRE EXTINGUISHER (9 KG) |
| 1 | ANGLE GRINDER |
| 1 | BABY GRINDER |
| 1 | FLINT LIGHTER |
| 1 | FIRE BLANKET |
| 1 | CHALK LINE |

6. Maintenance

Brelko Keyskirt® is designed to operate with minimum maintenance. However, to maintain superior performance some service is required. When the Keyskirt® is installed a regular maintenance program should be set up. This program will ensure that the Keyskirt® operates at optimal efficiency and problems can be identified and fixed before the Keyskirt® stops working. All safety procedures for inspection of equipment (stationary or operating) must be observed. Only visual observations can be made while the belt is running. Service tasks can be done only with the conveyor stopped and by observing the correct lockout/Tag-out procedures.

6.1. New Installation

After the new Brelko Keyskirt® has run for a few days a visual inspection should be made to ensure the Keyskirt® is performing properly.

6.2. Routine Visual Inspection (every 2~4 weeks)

A visual inspection of the Keyskirt® and the belt can determine:

- Check Keyskirt® for wear;
- Make sure that the clamps are tight;
- Make sure that the Keyskirt® is resting on the conveyor belt.

If any of the above conditions exist, a determination should be made on when the conveyor can be stopped for Keyskirt® Maintenance. When maintenance tasks are completed, test run the conveyor to ensure the Keyskirt® is performing properly.

PARTS LIST - REF. DRW. No.: KS1-008, KS1-021 & KS1-022

| ITEM No. | DESCRIPTION | SIZE | LENGHT (m) | BELT WIDTH (mm) | CODE |
|----------|---|--------|------------|-----------------|---------|
| A | Keyskirt® rubber per length | | | | |
| | Standard grade - 55 SH(A) | SIZE 1 | 10 | UP TO 900mm | 9-2.2-1 |
| | LHB (SOFT) - 40 SH(A) | SIZE 1 | 10 | UP TO 900mm | 9-2.7-1 |
| | Heat resistant - 55 SH(A) | SIZE 1 | 10 | UP TO 900mm | 9-2.3-1 |
| | F.R.A.S.O.R. - 55 SH(A) | SIZE 1 | 10 | UP TO 900mm | 9-2.4-1 |
| | Waste works - 60 SH(A) | SIZE 1 | 10 | UP TO 900mm | 9-2.6-1 |
| | Chemical - 60 SH(A) - Polyurethane | SIZE 1 | 2.5 | UP TO 900mm | 9-2.8-1 |
| | Food Grade - 60 SH(A) – Natural Rubber (FDA Approved) | SIZE 1 | 10 | UP TO 900mm | 9-2.5-1 |
| B | Keyskirt® channel track – C/W backing strip, nuts & washers | SIZE 1 | 1.25 | UP TO 900mm | 9-1.2.1 |

NOTE! Always quote belt width.

ASSEMBLY INSTRUCTIONS

1. Check that the correct quantities and size of components have been supplied as ordered by referring to parts list and DRW. No.: KS1-008.
2. Lightly assemble the track by fitting the clamp strip (2) to the backing plate (3).
3. Cut the Keyskirt® Rubber (1) to the required length.
4. If the Keyskirt® Rubber (1) needs to be joined into longer lengths refer to the Technical Bulletin KEY2 - 01/99, available on request.

KEYSKIRT SIZE 1 - CHUTE SEALING SYSTEM WITH FLEXIBLE RUBBER SKIRTING

© 08-2016

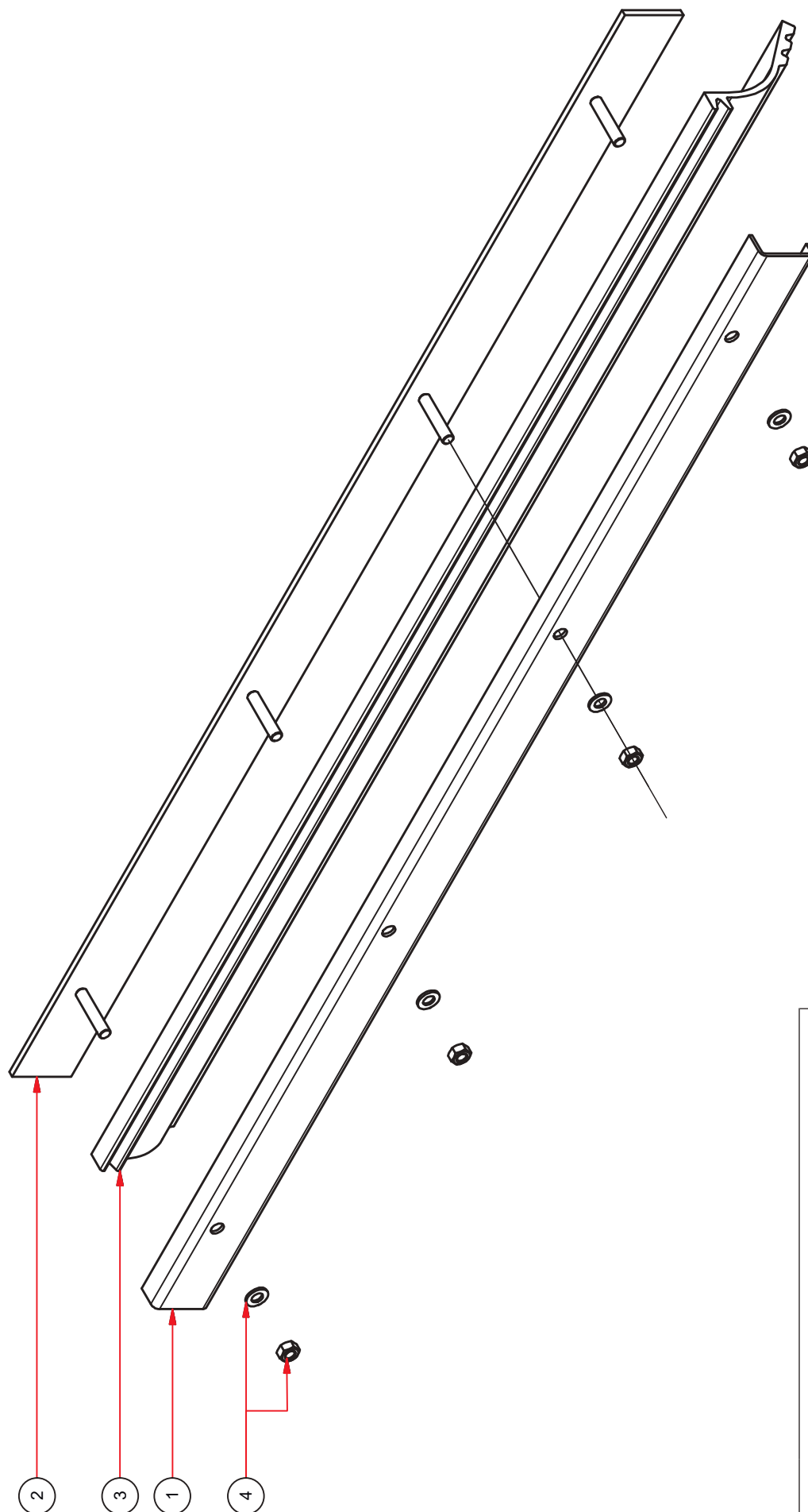

| LEGEND | |
|----------------|---|
| COMPONENT I.D. | DESCRIPTION |
| 1 | CHANNEL TRACK |
| 2 | BACKING STRIP C/W STUDS, NUTS & WASHERS |
| 3 | KEYSKIRT SIZE 1 |
| 4 | M10 NUTS & WASHER |

PARTS LIST: STANDARD MOUNT

DRW. KS1 - 008
No.

REV. D

KEYSKIRT SIZE 1 - CHUTE SEALING SYSTEM WITH FLEXIBLE RUBBER SKIRTING

© 08-2016

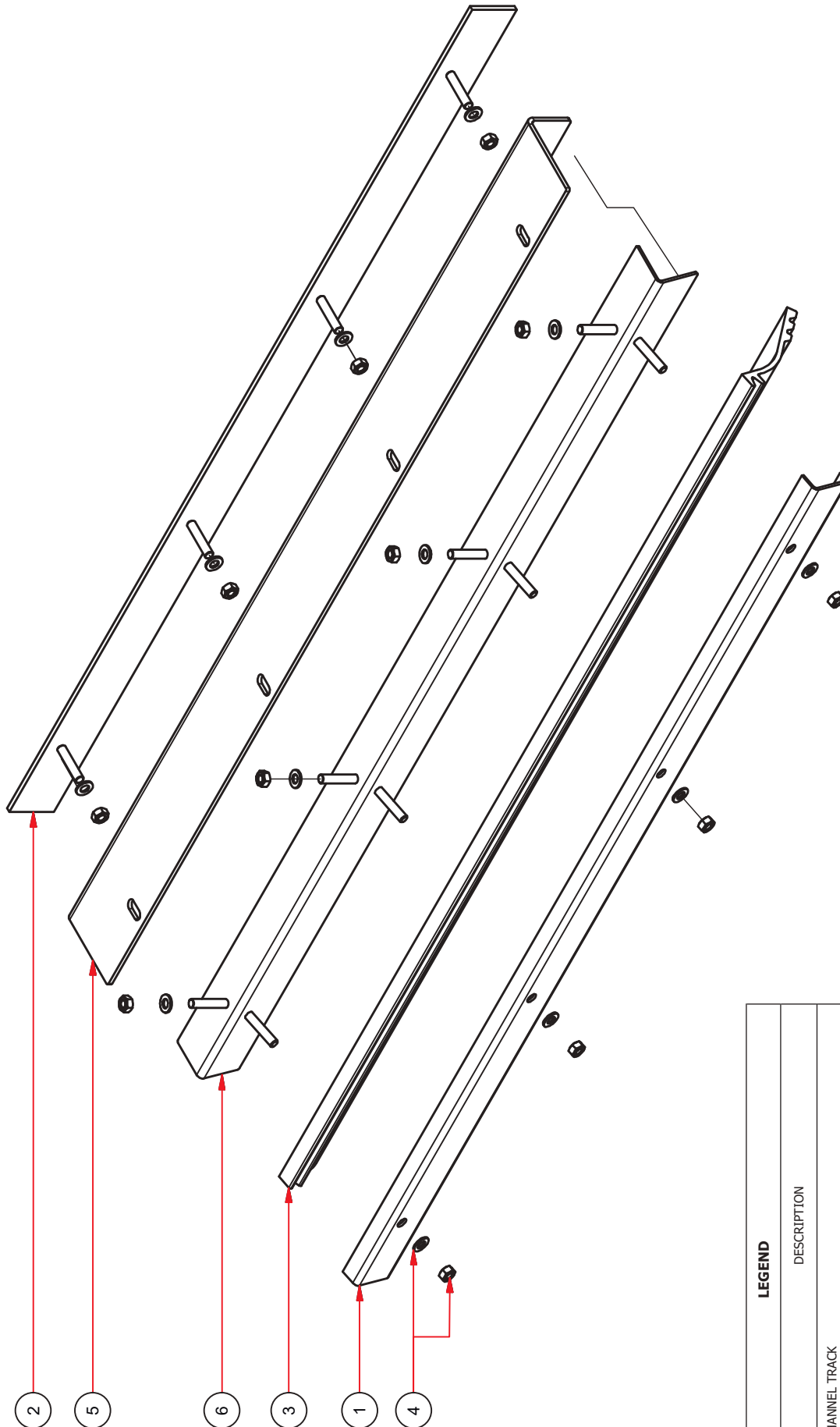

| LEGEND | |
|----------------|---|
| COMPONENT I.D. | DESCRIPTION |
| 1 | CHANNEL TRACK |
| 2 | BACKING STRIP C/W STUDS, NUTS & WASHERS |
| 3 | KEYSKIRT SIZE 1 |
| 4 | M10 NUTS & WASHER |
| 5 | OFF-SET BACKING STRIP |
| 6 | CHANNEL TRACK SUPPORT BRACKET |

PARTS LIST: OFFSET MOUNT

DRW. KS1 - 021
No.

REV. D

KEYSKIRT SIZE 1 - CHUTE SEALING SYSTEM WITH FLEXIBLE RUBBER SKIRTING

© 08-2016

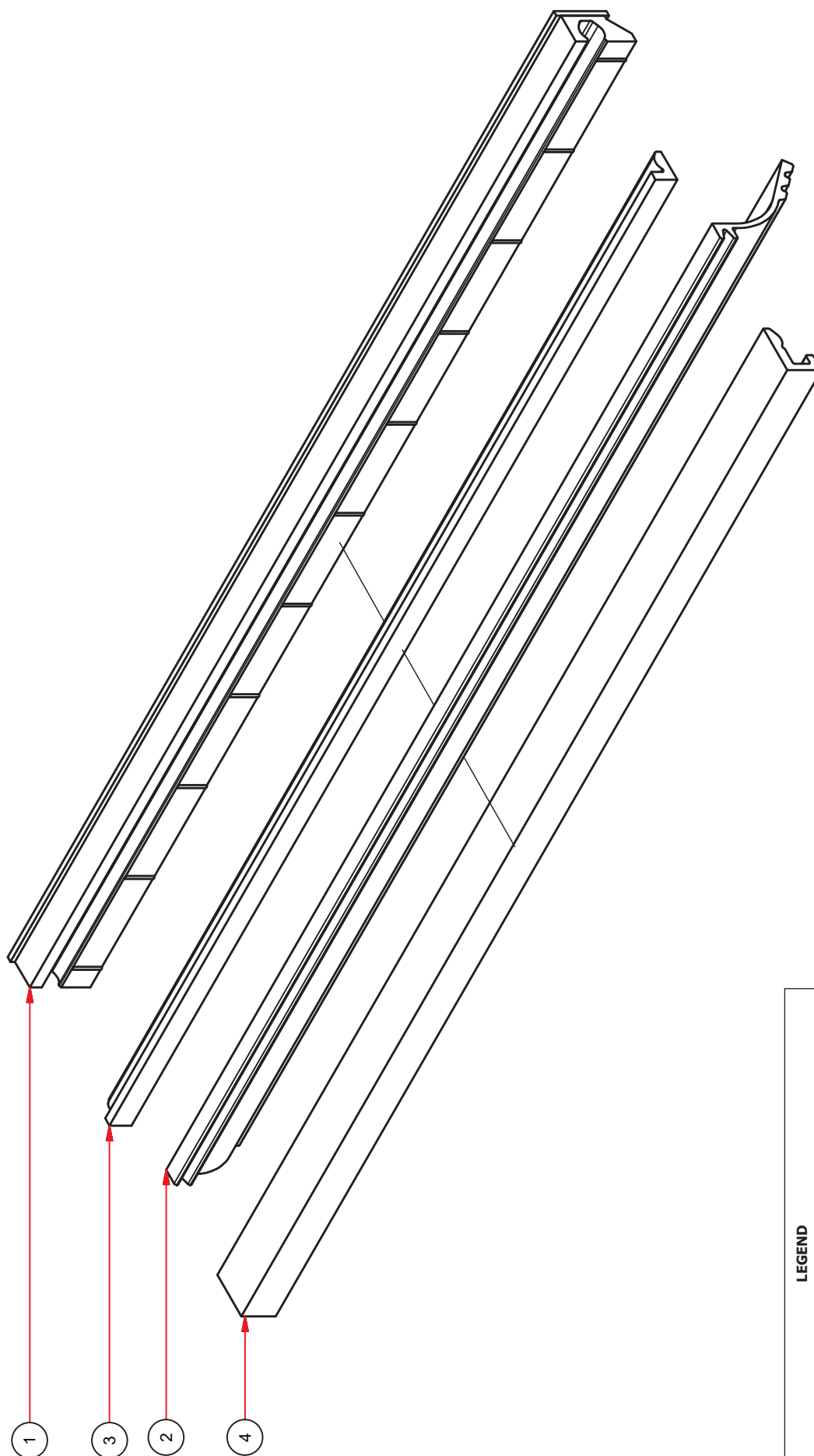

| LEGEND | |
|----------------|---|
| COMPONENT I.D. | DESCRIPTION |
| 1 | BACKING STRIP COMPLETE WITH BACKING PLATE |
| 2 | KEYSKIRT SIZE 1 |
| 3 | KEYLINER LOCKING STRIP |
| 4 | KEYLINER KEYSKIRT LOCKING STRIP |

PARTS LIST: BOLTLESS TRACK

DRW. No. KS1 - 022
REV. A

INSTALLATION GUIDE - REF. DRW. No.: KS1-009, KS1-023 & KS1-024

1. Select the most appropriate size and type of Keyskirt[®] for the application. Generally Size -1 is used for belt widths up to 900mm, Size -2 for wider belts up to 1200mm and Size -4 for wider belts. Size -3 skirting being used where the material particle size and drop height is such that Size -1, -2 & -4 may be damaged. White chemical grade Size -1 Keyskirt[®] is available with stainless steel clamp and channel track.
2. Ensure that the chute / belt clearance is sufficient as shown on the relevant drawings.
3. Mark out and weld the channel backing strips to the chute sides as shown on the drawing.
 - Note: If no backing strip is used refer to technical bulletin KEY1 – 01/99, available on request.
4. Where there is a long run of skirting check that the drag is not excessive. (Refer to data – see DRW. No.: KS1-007). It may be necessary to adjust the mounting angle of Size - 1 and -2 Keyskirt[®] to reduce drag. Brelko “KeyKlamps” are recommended for quick replacement of Keyskirt[®].
5. Size -1 and -2 Keyskirt[®] is supplied in 10m lengths and Size 4 in 5m or 10m lengths. They can be cut to size and also joined using suitable cold splicing compounds. (See technical bulletin KEY2 - 01/99, available on request).
6. Keyskirt[®] should be replaced when the ribs are worn away.
7. No running adjustments are required.
8. To further enhance the sealing benefit of Keyskirt[®] we recommend the installation of Brelko Feedboots at the various conveyor load points.
9. Ensure that the conveyor belt has been properly aligned and is tracking true so as to avoid Keyskirt[®] slipping off the belt edge.

KEYSKIRT SIZE 1 - CHUTE SEALING SYSTEMS WITH FLEXIBLE RUBBER SKIRTING

© 08-2016

BACKING PLATE

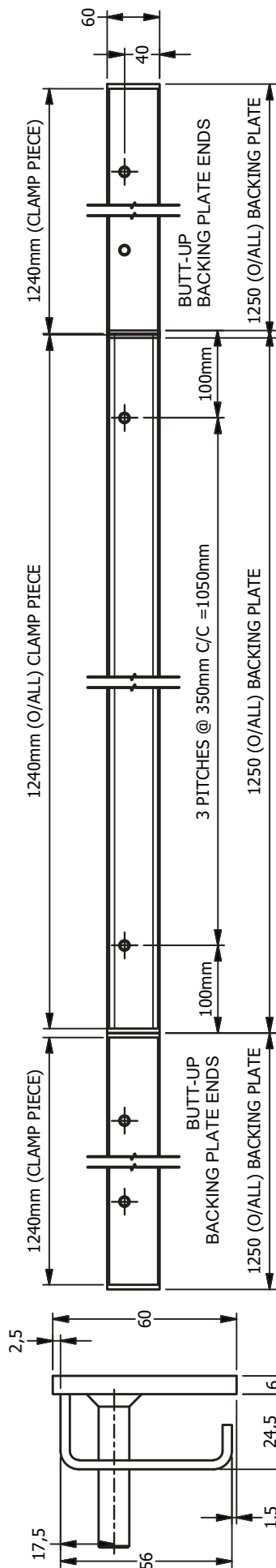

SIDE VIEW

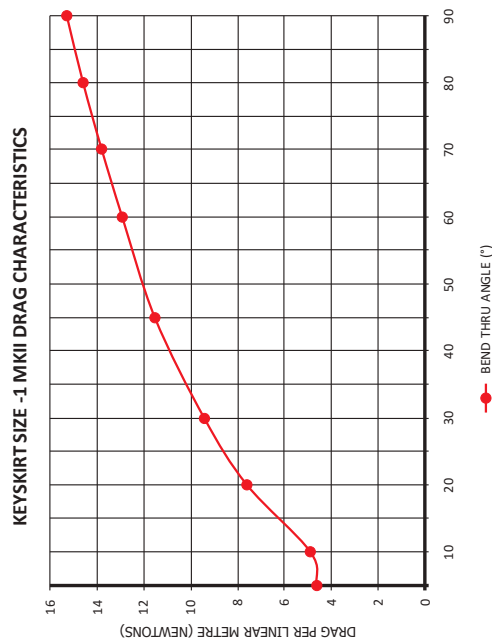
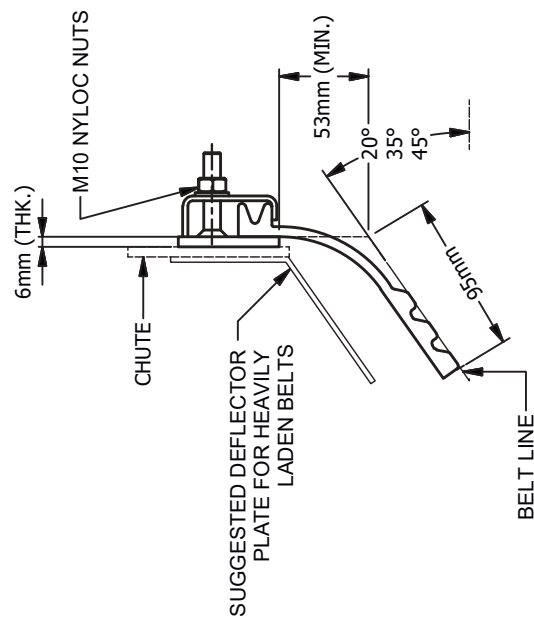
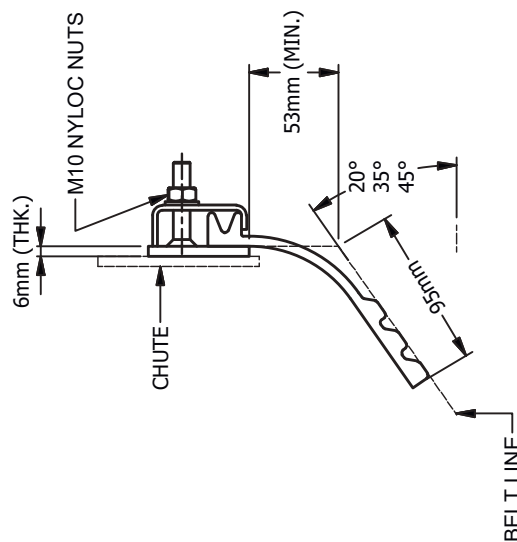

BACKING PLATE MOUNTING

BACKING PLATE MOUNTING

INSTALLATION DETAIL: STANDARD MOUNT

DRW. KS1 - 009
No.

REV. D

KEYSKIRT SIZE 1 - CHUTE SEALING SYSTEMS WITH FLEXIBLE RUBBER SKIRTING

© 08-2016

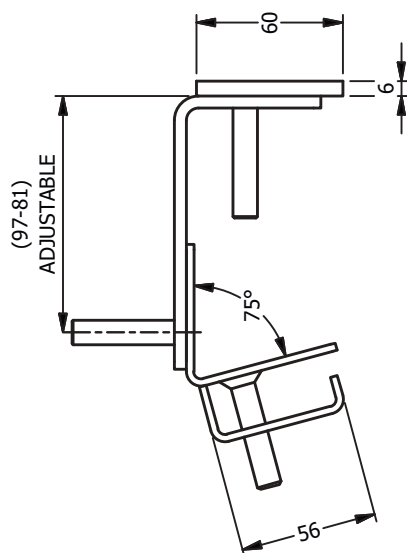

END VIEW

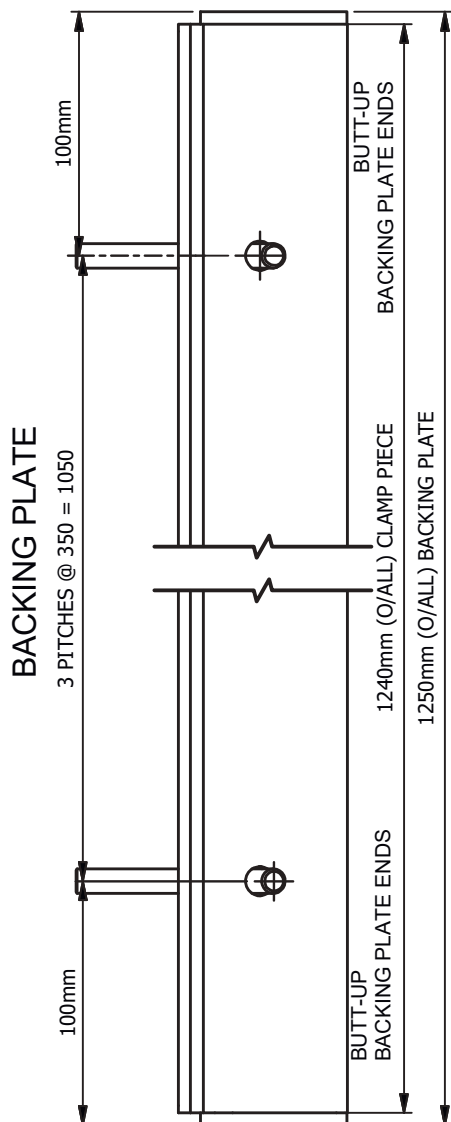

SIDE VIEW

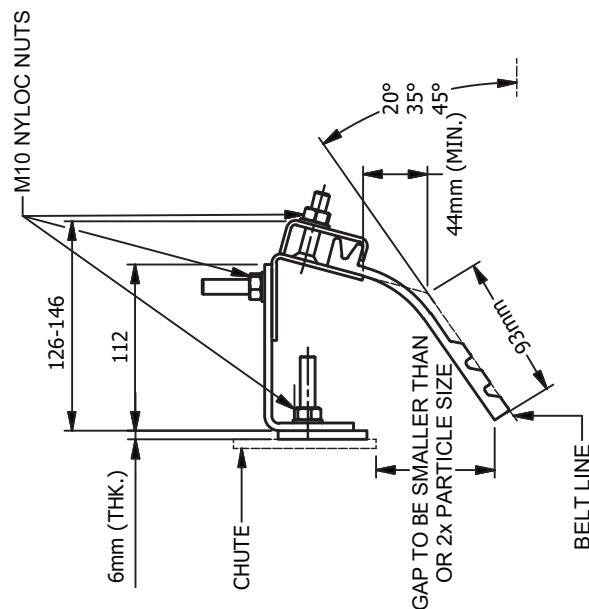

BACKING PLATE MOUNTING

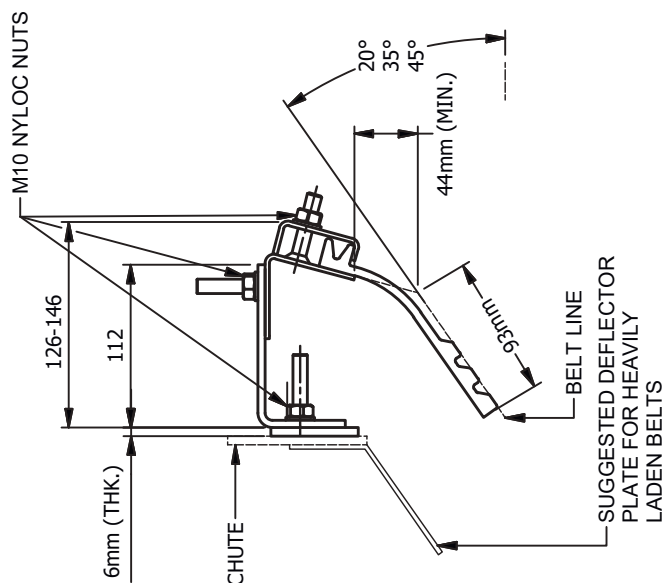

BACKING PLATE MOUNTING

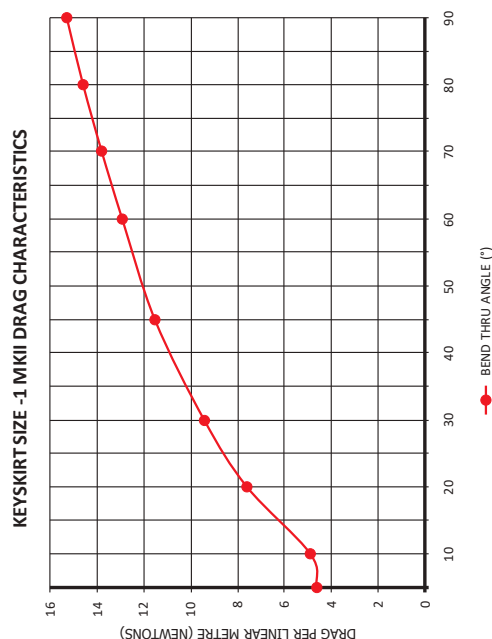

INSTALLATION DETAIL: OFFSET MOUNT

DRW. KS1 - 023
No.

REV. B

KEYSKIRT SIZE 1 - CHUTE SEALING SYSTEMS WITH FLEXIBLE RUBBER SKIRTING

© 08-2016

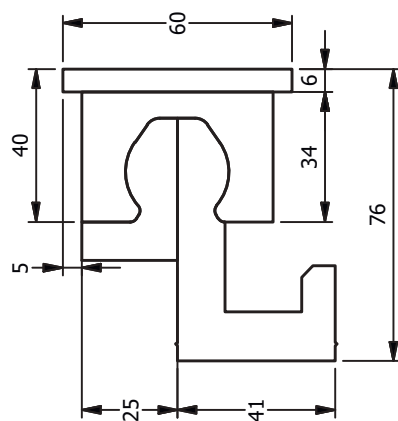

END VIEW

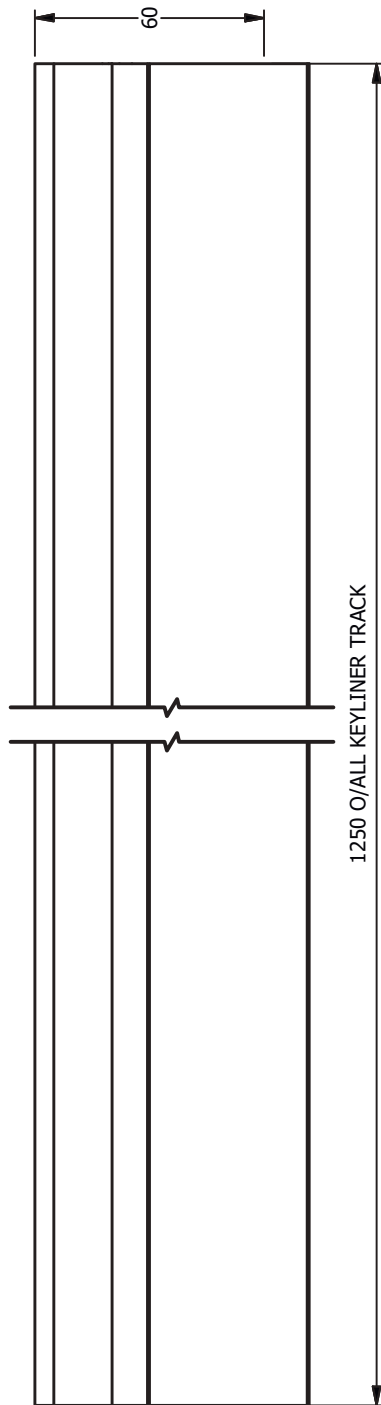

SIDE VIEW

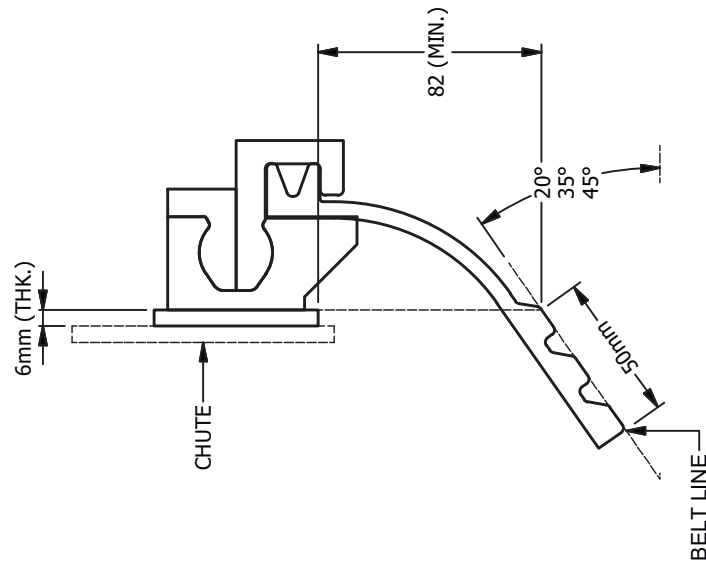

BACKING PLATE MOUNTING

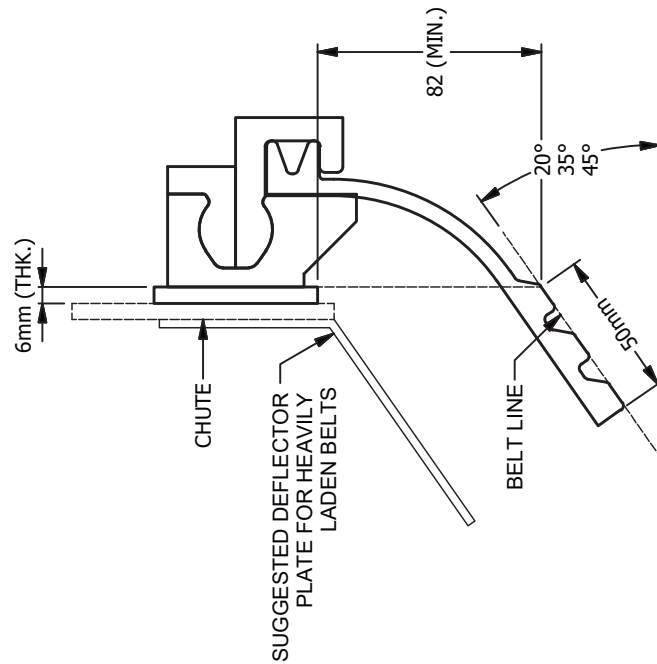

BACKING PLATE MOUNTING

KEYSKIRT SIZE -1 MKII DRAG CHARACTERISTICS

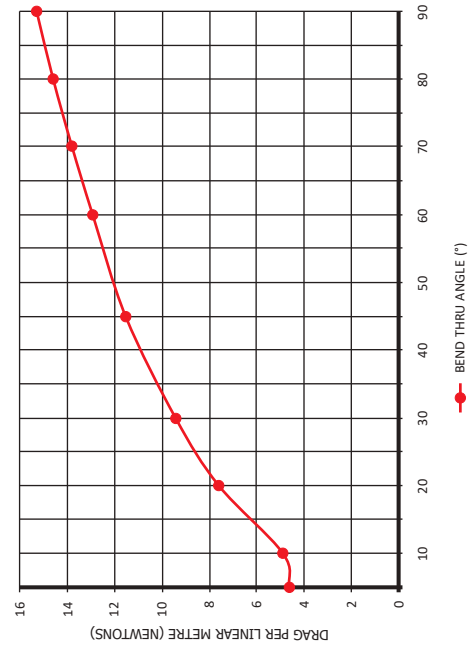

INSTALLATION DETAIL: BOLTLESS TRACK

DRW. KS1-024
No.

REV. A

7. Procedure for Replacing Keyskirt®

Repair/replace Keyskirt® components when, general maintenance tasks are preformed, damage due to accelerated wear, Keyskirt® damage due to clip joints, overloading etc.

- 7.1. Request permit to work from an authorised person, who will isolate and lock out the belt.
- 7.2. Loosen the locknuts and then remove the Keyskirt.
- 7.3. Keyskirt® replacement:

Refer to Brelko installation instructions for Keyskirt® model in use.

If Keyskirt® damaged occur follow the steps below to replace individual or all of the Keyskirt:

- 7.3.1 Ensure that the chute / belt clearance is sufficient as shown on the relevant drawings.
- 7.3.2 Mark out and weld the channel backing strips to the chute sides as shown on the drawing.
Note: If no backing strip is used refer to technical bulletin KEY1 – 01/99, available on request.
- 7.3.3 Where there is a long run of skirting check that the drag is not excessive. (Refer to data – see DRW. No.: KS1-007). It may be necessary to adjust the mounting angle of the Keyskirt® to reduce drag. Brelko “KeyKlamps” are recommended for quick replacement of Keyskirt.
- 7.3.4 Keyskirt® is supplied in 10m lengths. They can be cut to size and also joined using suitable cold splicing compounds. (See technical bulletin KEY2 - 01/99, available on request).
- 7.3.5 Keyskirt® should be replaced when the ribs are worn away.
- 7.3.6 No running adjustments are required.
- 7.3.7 To further enhance the sealing benefit of Keyskirt® we recommend the installation of Brelko Feedboots at the various conveyor load points.
- 7.3.8 Ensure that the conveyor belt has been properly aligned and is tracking true so as to avoid Keyskirt® slipping off the belt edge.
- 7.3.9 Clear up any loose items which resulted from your work.

CONVEYOR BELT & EQUIPMENT CHECK LIST / QCP

CUSTOMER DETAILS

| | | | |
|----------------|--|-----------------------|--|
| Customer Name: | | Contact Number: | |
| Attention: | | Date of Inspection | |
| Inspected By | | Brelko Representative | |

CONVEYOR DIMENSIONS

| | | | | | |
|----------------------|-----|-------------------|------------------|-------------------------|----|
| Belt Number: | | Material Carried: | | Belt Speed: | |
| Belt Length: | | Belt Width: | | Troughing Angle: | |
| Top Cover Condition: | | | | Bottom Cover Condition: | |
| Splice: | Yes | No | Clip Joint: | Yes | No |
| Conveyor Running | Yes | No | Inspection Tags: | Yes | No |
| Edge Damage: | Yes | No | | | |
| Comments: | | | | | |

HEAD END / HEAD CHUTE

| | | | |
|----------------------|--|----------------------|--|
| Chute Condition: | | Head Pulley Lagging: | |
| Snub Pulley Lagging: | | Build up: | |
| Belt Movement: | | | |
| Comments: | | | |

IDLER CHECK

| | | | |
|----------------------------|--|-------------------------|--|
| Trough Idler Condition: | | Return Idler Condition: | |
| Troughing Frame Condition: | | Return Frame Condition: | |
| Comments: | | | |

PRIMARY SCRAPER

| | | | | |
|--|-----|--------|------------------------------------|-----------|
| Position Correct: | Yes | No | Type of Primary Scraper installed: | |
| (Contact of Scraper Blade must be between 10 to 30 degrees, under the pulley horizontal line.) | | | | |
| Mounts firmly mounted: | Yes | No | All bolts, nuts tightened: | Yes |
| Adequate Tensioning: | Yes | No | All Caps, Denso Tape in place: | Yes |
| Housekeeping: | | | | |
| Chute Material build up: | | | | |
| Blade Wear: | Low | Medium | High | Cleaning: |
| Comments: | | | | |

SECONDARY SCRAPER #1

| | | | | | |
|--|-----|--------|------------------------------|-----------|------|
| Type / Model of Secondary Scraper Installed: | | | | | |
| Positioning Correct: | | | | | |
| (Scraper blade must preferably be a minimum 100mm from pulley tangent.) | | | | | |
| All Caps, Denso Tape in Place: | Yes | No | Mounts firmly mounted: | Yes | No |
| All Bolts & Nuts Tightened: | Yes | No | Adequate tension/adjustment: | Yes | No |
| Angle Correct Set: | Yes | No | Carrier Frame cut to size | Yes | No |
| Angle of scraper must be 90 degrees to the conveyor belt, dependant on conditions. | | | | | |
| Chute / Material build up: | Yes | No | Housekeeping: | | |
| Blade wear: | Low | Medium | High | Cleaning: | Poor |
| Comments: | | | | | |

SECONDARY SCRAPER #2

| | | | | | | | | | | | |
|--|-----|--|--------|--|------------------------------|-----------|------|----|------|--|------|
| Type / Model of Secondary Scraper Installed: | | | | | | | | | | | |
| Positioning Correct: | | | | | | | | | | | |
| Scraper blade must preferably be a minimum 100mm from pulley tangent. | | | | | | | | | | | |
| All Caps, Denso Tape in Place: | Yes | | No | | Mounts firmly mounted: | Yes | | No | | | |
| All Bolts & Nuts Tightened: | Yes | | No | | Adequate tension/adjustment: | Yes | | No | | | |
| Angle Correct Set: | Yes | | No | | Carrier Frame cut to size | Yes | | No | | | |
| Angle of scraper must be 90 degrees to the conveyor belt, dependant on conditions. | | | | | | | | | | | |
| Chute / Material build up: | Yes | | No | | Housekeeping: | | | | | | |
| Blade wear: | Low | | Medium | | High | Cleaning: | Poor | | Fair | | Good |
| Comments: | | | | | | | | | | | |

TAKE UP PULLEYS / COUNTERWEIGHT / PLOUGH

| | | | | | | | | | | | |
|-----------------------------------|------------|-----|----|----|---|----------|-----|----|----|--|--|
| Type / Model of Plough Installed: | | | | | | | | | | | |
| Are Flat Return Idlers Installed: | (In front) | Yes | | No | | (Behind) | Yes | | No | | |
| Any excessive belt movement: | Yes | | No | | Adequate space for material to fall off of conveyor belt | Yes | | No | | | |
| Is the Plough firmly mounted: | Yes | | No | | Is the Safety Chain firmly mounted and correctly adjusted: | Yes | | No | | | |
| Is the Plough Free moving: | Yes | | No | | Is the entire Blade / Nose Piece in contact with the conveyor belt: | Yes | | No | | | |
| Housekeeping: | | | | | | | | | | | |
| Comments: | | | | | | | | | | | |

CONVEYOR BELT TRACKING / ALIGNMENT

| | | | | | | | | | |
|---|-----|--|----|--|--|-----------|---------------|--------|--|
| Is the Belt Tracking centre: | Yes | | No | | Are there any Tracking Systems installed: | Troughing | | Return | |
| Is there any visible damage to structure caused by poor belt tracking: | Yes | | | | No | | | | |
| Conveyor belt length: | | | | | Are the tracking systems correctly positioned: | Yes | | No | |
| Are the tracking systems firmly mounted: | Yes | | No | | Are all bolts & nuts tightened: | Yes | | No | |
| Are all Idlers in contact with the Belt - Adequate Tension on the system: | Yes | | | | No | | Housekeeping: | | |
| Comments: | | | | | | | | | |

LOADING / TRANSFER CHUTE

| | | | | | | | | | | | |
|-----------------------|------|--|------|------|-------------------|------|--|----|--|---------------|--|
| Chute Condition: | Poor | | Fair | | Good | | Material loading in centre of conveyor belt: | | | | |
| Dead Boxes: | Yes | | No | | Deflector Plates: | Yes | | No | | Drop Heights: | |
| Tail Pulley Condition | Good | | | Fair | | Poor | | | | | |
| Comments: | | | | | | | | | | | |

KEYSKIRTING®

| | | | | | | | | | | | | |
|-------------------------------------|------|--|---|----|---|---------------|--------|--------------------------------|---------------------------------|-------|----|-------|
| Size of Keyskirt®: | 1 | | 2 | | 3 | | 4 | | Length of Keyskirt® Installed : | | | |
| Positioning of Keyskirt® : | | | | | | | | Other Product used as Skirting | Yes | | No | State |
| Mounting Arrangement | Std. | | | | | | Offset | | | Other | | |
| All bolts & nuts securely fastened: | Yes | | | No | | Housekeeping: | | | | | | |
| Comments: | | | | | | | | | | | | |

FEEDBOOTS

| | | | | | | | | | |
|---------------------------------------|-----------|--|-------------|--|---|------|--|--------|--|
| Type of Feedboot installed: | Universal | | Combination | | Is the system correctly positioned: | Yes | | No | |
| | | | | | (System to be positioned centrally to the load area.) | | | | |
| Drop Height: | | | | | Is the system securely mounted: | Yes | | No | |
| All Bolts & Nuts tightened: | Yes | | No | | Condition of Idlers: | Poor | | Fair | |
| Lead in and lead out Idlers in place: | Yes | | No | | Condition of UHMW Liners: | Low | | Medium | |
| Housekeeping: | | | | | | | | | |
| Comments: | | | | | | | | | |

HI - IMPACT SYSTEM

| | | | | | | | | | |
|---|------|--|------|--|-----------------------------|---|-----|------|----|
| Type of Hi - Impact system installed: | | | | | | | | | |
| Is the system correctly positioned: | Yes | | No | | Drop heights: | | | | |
| System to be positioned centrally to the load area. | | | | | | | | | |
| Is the system securely mounted: | Yes | | No | | All bolts & nuts tightened: | Yes | | No | |
| Are all Idlers in contact with the belt: | Yes | | No | | Idler condition: | Poor | | Fair | |
| BTA Condition: | Poor | | Fair | | Good | Are chains / D shackles in place & securely fastened: | Yes | | No |
| All Hardware in Good Condition: | Yes | | No | | Housekeeping: | | | | |
| Comments: | | | | | | | | | |

AIR CANNONS

| | | | | | | | | |
|---|--------------|--|----------|--|---|-----|------------|----|
| Size of Air Cannon Installed: | 5ltr | | Quantity | | 10ltr | | Quantity | |
| | 25ltr | | Quantity | | 50ltr | | Quantity | |
| | 100ltr | | Quantity | | 200ltr | | Quantity | |
| Is the Air Cannon securely fastened onto the structure: | Yes | | No | | Is an Air Lance installed: | Yes | | No |
| Size of the Air Lance: | | | | | Are the Air Cannons correctly positioned: | Yes | | No |
| Power supply: | | | | | Air supply: | | | |
| Operating system: | Single timer | | PLC | | Manual push button | | Sequential | |
| All Bolts & Nuts securely tightened: | Yes | | No | | All components in good order: | Yes | | No |
| Distance between Air Cannon & Solenoid Valve: | | | | | Any Air Leaks in the Pipe Work: | No | | |
| Is a Water Trap Installed: | Yes | | No | | Is a Lubricator installed: | Yes | | No |
| Distance from Air Cannon: | | | | | Distance from Air Cannon: | | | |
| Are the safety / warning signs in place and visible: | Yes | | No | | Housekeeping: | | | |
| Comments: | | | | | | | | |

TAIL PULLEY / PLOUGH

| | | | | | | | | |
|-----------------------------------|------------|-----|----|----|---|----------|-----|----|
| Type / Model of Plough Installed: | | | | | | | | |
| Are Flat Return Idlers installed: | (In front) | Yes | | No | | (Behind) | Yes | |
| Any excessive belt movement: | Yes | | No | | Adequate space for material to fall off of conveyor belt: | Yes | | No |
| Is the Plough firmly mounted: | Yes | | No | | Is the Safety Chain firmly mounted and correctly adjusted: | Yes | | No |
| Is the Plough free moving: | Yes | | No | | Is the entire Blade / Nose Piece in contact with the conveyor belt: | Yes | | No |
| Housekeeping: | | | | | | | | |
| Comments: | | | | | | | | |

Brelko Supervisor

Name: _____

Date: _____

Signature: _____

Customer

Name: _____

Date: _____

Signature: _____



ISO 9001:2015
ISO 14001:2015
ISO 45001:2018

| DOC No | ISSUE No | REVISION | OCTOBER | PAGE |
|--------|----------|----------|---------|-------------|
| FS 023 | 04 | 04 | 2018 | Page 3 of 3 |



10. Trouble Shooting

| Problem | Possible Cause | Possible Solution |
|---|---|--|
| Keyskirt [®] damaged | Belt Drift | Fit Belt Tracking Systems, preferably fit Brelko Belt Tracking Systems |
| | Material being loaded directly onto Keyskirt [®] | Replace with smaller size of Keyskirt [®] |
| | | Offset Keyskirt [®] , preferably fit Brelko Keyskirt [®] Offset Channel Track. |
| | | Install material deflector plates |
| Keyskirt [®] not sitting flush with belt | Incorrect Installation | Reposition Keyskirt [®] , to ensure all ribs are in contact with the conveyor belt. |
| Excessive Wear / Drag | Incorrect bend through angle | Offset Keyskirt [®] , preferably fit Brelko Keyskirt [®] Offset Channel Track. |
| | Excessive material loaded onto Keyskirt [®] | Offset Keyskirt [®] , preferably fit Brelko Keyskirt [®] Offset Channel Track. |
| | | Install material deflector plates |